



Naylors

ESTATE AGENTS CHARTERED SURVEYORS



Leicester Road, Market Harborough, LE16 7BN

£25,000 Per Annum

Detached, purpose built two floor office block situated on the fringe of Market Harborough with car park.

Space is laid out over two floors and currently used as a board room with four offices along with a reception, two cloakrooms and two fully equipped kitchens.

Short term lease available 12 to 24 months.

Viewing

Please contact our Market Harborough Office on 01858 450020 if you wish to arrange a viewing appointment for this property or require further information.

- CCTV
- SECURITY ID CARD ACCESS
- PARKING
- STORAGE AREAS
- GAS CENTRAL HEATING
- FULLY FITTED KITCHENS
- TWO CLOAKROOMS
- EPC = B



null



null



null

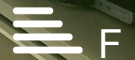

F

Floor Plan

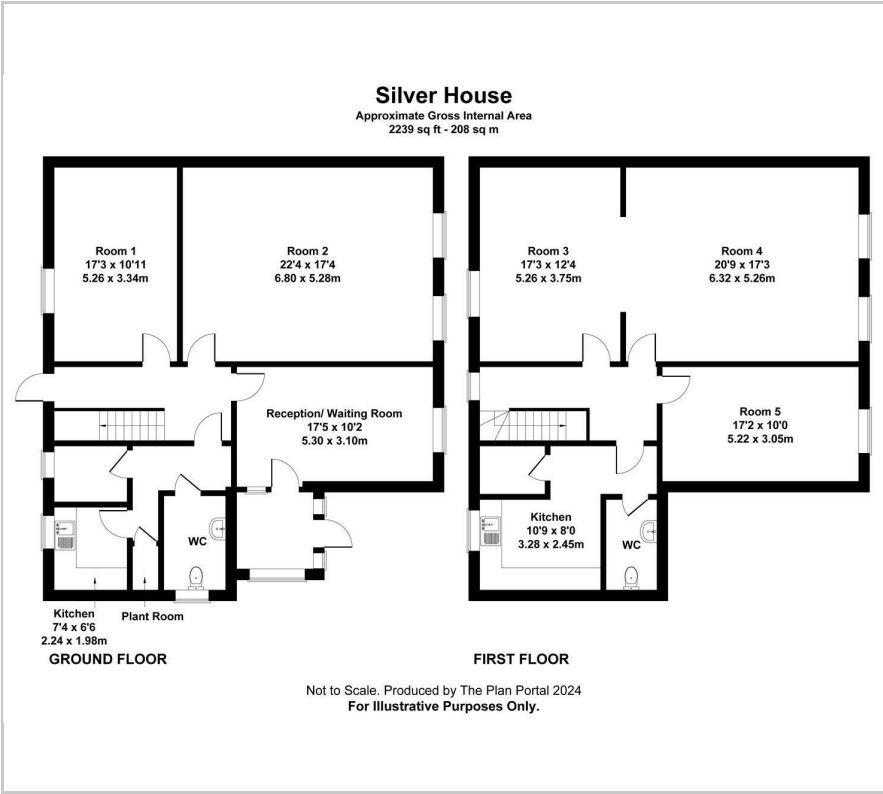

Area Map



Energy Efficiency Graph

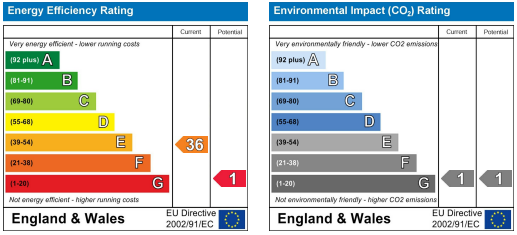

These particulars, whilst believed to be accurate are set out as a general outline only for guidance and do not constitute any part of an offer or contract. Intending purchasers should not rely on them as statements of representation of fact, but must satisfy themselves by inspection or otherwise as to their accuracy. No person in this firms employment has the authority to make or give any representation or warranty in respect of the property.

12 The Square, Market Harborough, LE16 7PA
Tel: 01858 450020 Email: sales@naylorsestateagents.com naylorsestateagents.com